

CITY OF TODD MISSION

2022 TxCDBG STREET REHABILITATION

TxCDBG CONTRACT NO. CDV21-202

MAYOR

GEORGE C. COULAM

COUNCIL MEMBERS

BRETT BRATCHER

STEPHEN MENSING-MAYOR PRO TEM

TIM JAMES

HEATHER MOON-WHINNERY

MIKE EUBANK

POSITION 1

POSITION 2

POSITION 3

POSITION 4

POSITION 5

CITY MANAGER

NEAL WENDELE

CITY SECRETARY

JULIE LUNSFORD



STRAND ASSOCIATES, INC.
BRENHAM, TEXAS

This document is released for the purpose of review under the authority of Jared D. Engelke, P.E. 138204 on November 14, 2022. It is not to be used for construction, bidding, or permit purposes.

DATE:

REVISIONS

NO.

TITLE SHEET

CITY OF TODD MISSION
2022 TxCDBG STREET REHABILITATION

JOB NO.

4695.002

PROJECT MGR.

JDE

TBPE No. F-8405



STRAND ASSOCIATES®

SHEET

1

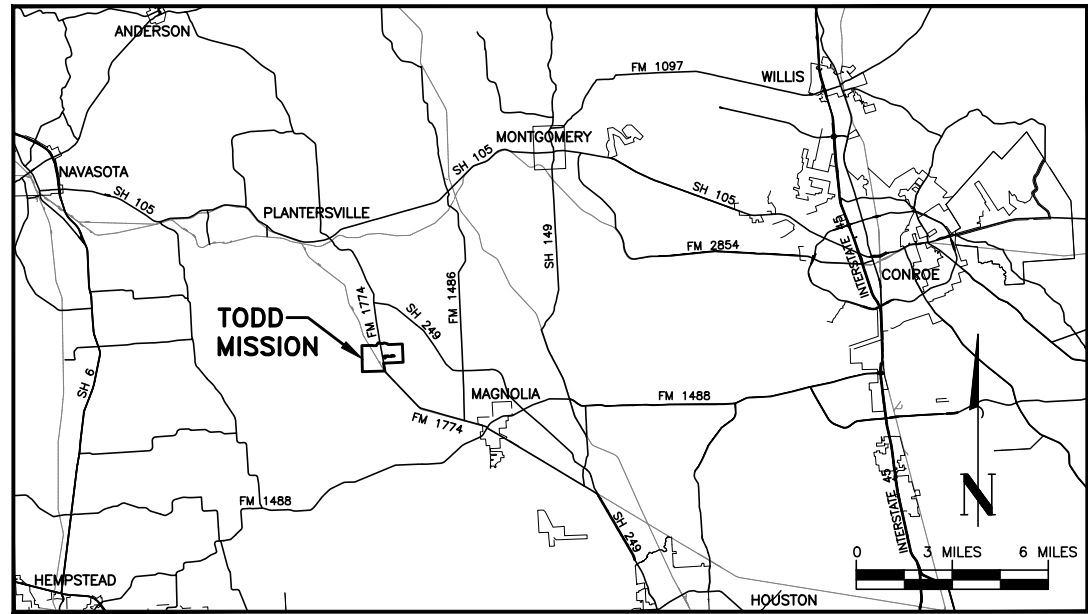

VICINITY MAP
SEE BARSCALE

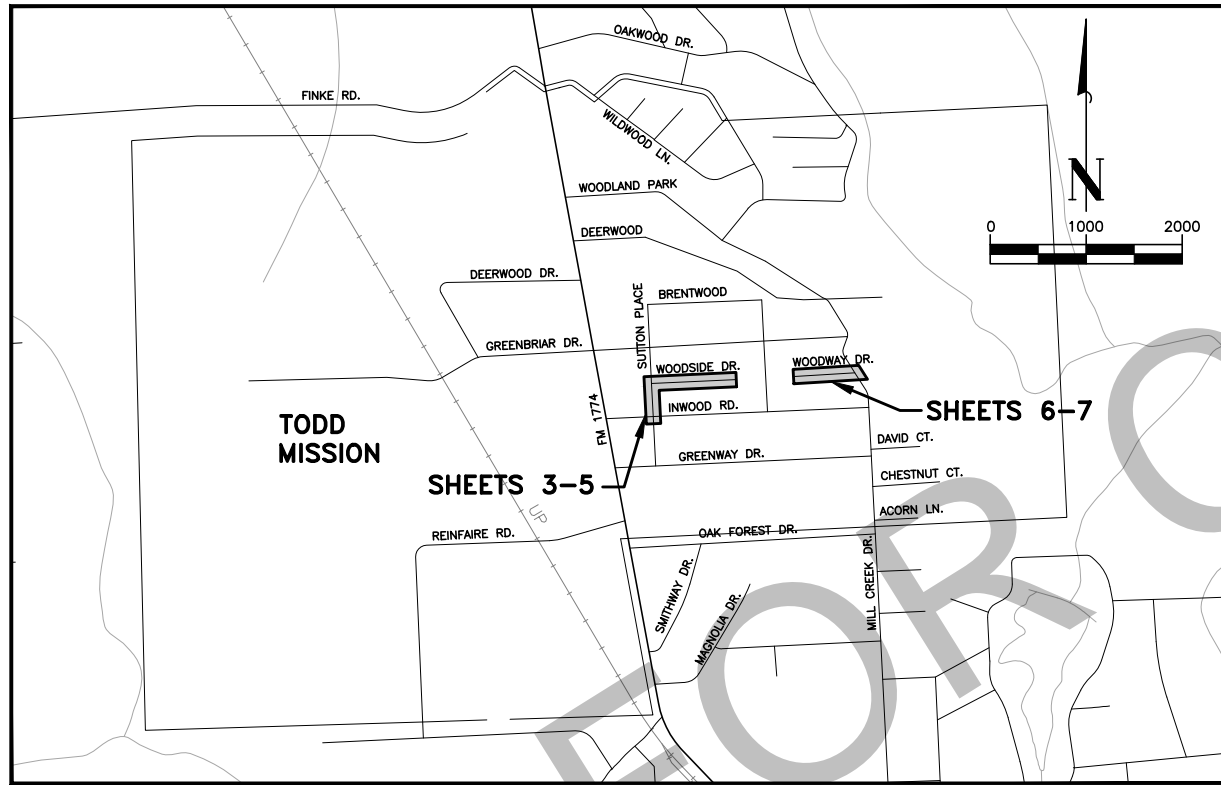

PROJECT LOCATION MAP
SEE BARSCALE

SHEET LIST TABLE	
SHEET NUMBER	SHEET TITLE
1	TITLE SHEET
2	PROJECT LOCATION MAP, LEGEND, GENERAL NOTES, & SHEET INDEX
3	SUTTON PLACE PLAN AND PROFILE STA. 10+00 - 15+50
4	WOODSIDE DR. PLAN AND PROFILE STA. 15+50 - 21+00
5	WOODSIDE DR. PLAN AND PROFILE STA. 21+00 - 23+35
6	WOODWAY DR. PLAN AND PROFILE STA. 30+00 - 34+00
7	WOODWAY DR. PLAN AND PROFILE STA. 34+00 - 36+25
8	PAVING DETAILS

EXISTING FEATURES LEGEND

SYMBOLS:	DESCRIPTION:
— X — X — X — X —	BARBED WIRE FENCE
— □ — □ — □ — □ —	BOARD FENCE
— ○ — ○ — ○ — ○ —	CHAIN LINK FENCE
— — — — —	DITCH
— + — + — + — + —	RAILROAD CROSSING
— T — T — T — T —	TELEPHONE LINE
— OE — OE — OE — OE —	OVERHEAD ELECTRICAL LINE
— UE — UE — UE — UE —	UNDERGROUND ELECTRICAL LINE
— G — G — G — G —	GAS LINE
— S — S — S — S —	SEWER LINE
— W — W — W — W —	WATER LINE
— — — — —	TOP/TOE OF SLOPE
— FO — FO — FO — FO —	FIBER OPTIC LINE
	BRUSH
⊂	CLEANOUT
●	CONCRETE MONUMENT
⊕	FIRE HYDRANT
■	GAS METER
○	GAS RISER
⊗	GAS VALVE
←	GUY WIRE
○	IRON PIPE OR ROD
□	MAILBOX
○	SEWER MANHOLE
⊙	METER POLE OR LIGHT
⊕	UTILITY POLE
⊗	SHRUB/BUSH/HEDGES
⊙	STORM SEWER MANHOLE
⊕	STREET SIGN
□	TELEPHONE PEDESTAL
⊕	TELEPHONE MANHOLE
⊙	TREE (CANOPY NOT MEASURED UNLESS SHOWN OTHERWISE)
⊕	WATER METER
⊗	WATER VALVE
*	SPRINKLER HEAD
⊗	IRRIGATION VALVE
△	SURVEY CONTROL
⊕	TBM BENCHMARK
— — — — —	ASPHALT PAVEMENT
— — — — —	CONCRETE PAVEMENT
— — — — —	GRAVEL PAVEMENT

GENERAL NOTES:

- IN ADDITION TO THE OTHER NOTIFICATIONS REQUIRED BY THE SPECIFICATIONS AND CONTRACT DOCUMENTS, THE CONTRACTOR SHALL NOTIFY THE CITY OF TODD MISSION, AT (936)894-3001, AND STRAND ASSOCIATES, INC., AT (979)836-7937, WHEN THE FOLLOWING PHASES OF CONSTRUCTION ARE ABOUT TO BEGIN:
(a) 48 HOURS BEFORE ACTUAL WORK BEGINS, AND
- CONTRACTOR SHALL HAVE ALL UNDERGROUND UTILITY LINES LOCATED AT LEAST 48 HOURS BEFORE DIGGING.
- CONTRACTOR SHALL HAVE SOLE RESPONSIBILITY TO PROVIDE FOR TRAFFIC CONTROL IN ACCORDANCE WITH THE LATEST EDITION OF THE TEXAS MANUAL OF UNIFORM TRAFFIC CONTROL DEVICES. IN THE EVENT OF STREET CLOSURES, CONTRACTOR SHALL NOTIFY ALL EMERGENCY SERVICE PROVIDERS AT LEAST 24 HOURS PRIOR TO CLOSING STREETS TO TRAFFIC.
- ANY PROPERTY BOUNDARY MONUMENTS DISTURBED BY CONTRACTOR SHALL BE REPLACED TO THE ORIGINAL CONDITION BY A REGISTERED PROFESSIONAL SURVEYOR AT CONTRACTOR'S EXPENSE.
- CONTRACTOR SHALL REPAIR ALL ADJACENT PROPERTY OWNERS' FENCES DISTURBED BY CONSTRUCTION TO A CONDITION EQUAL TO OR BETTER THAN ORIGINAL CONDITION.
- ANY UNPAVED AREA DISTURBED BY CONTRACTOR SHALL BE GRADED, SHAPED AND SEEDED PER TECHNICAL SPECIFICATION 32 92 19.
- EROSION CONTROL MEASURES SHALL CONFORM TO ALL STATE AND FEDERAL REQUIREMENTS, AND SHALL BE MAINTAINED THROUGHOUT THE CONSTRUCTION OF THE PROJECT.
- CONTRACTOR SHALL PROVIDE RESIDENTS ACCESS TO THEIR HOMES AFTER WORKING HOURS AND ON WEEKENDS.
- THE CONTRACTOR SHALL BE AWARE THAT OVERHEAD POWER AND TELEPHONE LINES EXIST WITHIN THE PROJECT AREA. THE CONTRACTOR SHALL INSURE THAT ALL EQUIPMENT MAINTAINS A MINIMUM SAFE CLEARANCE FROM ALL ENERGIZED POWER LINES.
- THE CONTRACTOR SHALL PROTECT EXISTING YARDS, BOTH PUBLIC AND PRIVATE, DRIVES, CURBS, MAIL BOXES, SIGNS, CULVERTS, ETC. FROM DAMAGE DURING CONSTRUCTION. DAMAGES DONE TO THESE ITEMS SHALL BE REPAIRED AT THE CONTRACTOR'S EXPENSE. THE CONTRACTOR SHALL MOVE AND REINSTALL SUCH MOVABLE OBJECTS AS MAIL BOXES, TRAFFIC CONTROL AND STREET SIGNS AS NECESSARY FOR CONSTRUCTION.
- THE CONTRACTOR SHALL DISPOSE OF ALL SURPLUS MATERIALS FROM THE PROJECT IN A MANNER ACCEPTABLE TO THE OWNER AND THE ENGINEER AND IN ACCORDANCE WITH ALL APPLICABLE FEDERAL, STATE AND LOCAL REGULATIONS.
- AREAS DISTURBED BY CONSTRUCTION SHALL BE SEEDED AND FERTILIZED IN ACCORDANCE WITH SECTION 32 92 19 OF THE TECHNICAL SPECIFICATIONS.
- DIMENSIONS ON STREETS ARE FROM THE BACK OF CURB UNLESS OTHERWISE NOTED IN THE PLANS.
- THE CONTRACTOR IS RESPONSIBLE FOR ESTABLISHING THE EXACT LOCATION OF UTILITIES. IF UTILITY LINES ARE ENCOUNTERED DURING MIXING OPERATIONS OF THE TOP 6" OF EXISTING ROADWAY, THE OWNER WILL BE RESPONSIBLE FOR THEIR REPAIR. IF THE CONTRACTOR ENCOUNTERS UTILITY LINES BEYOND THE 6" DEPTH, HE WILL BE RESPONSIBLE FOR THEIR REPAIR IF DAMAGED.
- THE CONTRACTOR SHALL REMOVE EXISTING VEGETATION FROM ALL STREETS PRIOR TO CONSTRUCTION. NO SEPARATE PAYMENT WILL BE MADE FOR VEGETATION REMOVAL.
- THE PLANS SHOW EXISTING MANHOLES, CLEANOUTS AND VALVES THAT ARE BOTH VISIBLE FROM THE SURFACE AND BURIED. THE CONTRACTOR SHALL ADJUST THE ELEVATION OF THE TOPS OF ALL OF THESE ITEMS SHOWN ON THE PLANS TO MATCH THE FINISHED STREET GRADE PRIOR TO PLACING THE FINAL SURFACE. THE USE OF MANHOLE AND VALVE BOX EXTENSIONS FROM AN APPROVED MANUFACTURER IS AN APPROVED METHOD FOR RAISING THE TOPS OF THESE ITEMS. NO SEPARATE PAYMENT WILL BE MADE FOR RAISING THE ITEMS SHOWN ON THE PLANS. A SEPARATE SUPPLEMENTAL BID ITEM IS INCLUDED FOR THOSE FEATURES WHICH ARE BURIED AND NOT SHOWN ON THE PLANS.
- NON-PAVED AREAS DISTURBED BY CONSTRUCTION SHALL HAVE A MINIMUM OF 4" OF TOPSOIL WHEN COMPLETE TO ESTABLISH VEGETATION.
- THE CONTRACTOR SHALL MAKE EVERY REASONABLE EFFORT TO KEEP ALL STREETS, ROADS ALLEYS, RIGHTS-OF-WAY, AND/OR EASEMENTS OPEN TO THE PUBLIC AND MAINTAIN ACCESS TO ALL ADJOINING PROPERTIES DURING CONSTRUCTION. IF IT BECOMES NECESSARY TO INTERRUPT ACCESS TO PRIVATE PROPERTY, THE CONTRACTOR SHALL GIVE THE AFFECTED PARTIES ADEQUATE ADVANCE NOTICE OF THE DATE AND DURATION OF THE INTERRUPTION OF ACCESS. IF IT BECOMES NECESSARY TO CLOSE A STREET, ROAD, ALLEY OR OTHER PUBLIC RIGHT-OF-WAY, THE CONTRACTOR SHALL GIVE ADEQUATE ADVANCE NOTICE TO THE AGENCIES; THE FIRE DEPARTMENT; THE EMS; THE SCHOOL DISTRICT'S TRANSPORTATION DEPARTMENT; AFFECTED AMBULANCE SERVICES; AND ALL AFFECTED UTILITIES.

This document is released for the purpose of review under the authority of Jared D. Engelke, P.E. 138204 on November 14, 2022. It is not to be used for construction, bidding, or permit purposes.

DATE:	REVISIONS:	NO.:

PROJECT LOCATION MAP, LEGEND, GENERAL NOTES, & SHEET INDEX
CITY OF TODD MISSION
2022 TxCDBG STREET REHABILITATION

JOB NO.
4695.002

PROJECT MGR.
JDE

TBPE No. F-8405

STRAND ASSOCIATES

SHEET
2

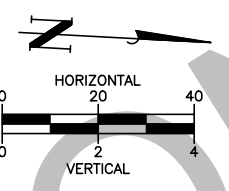
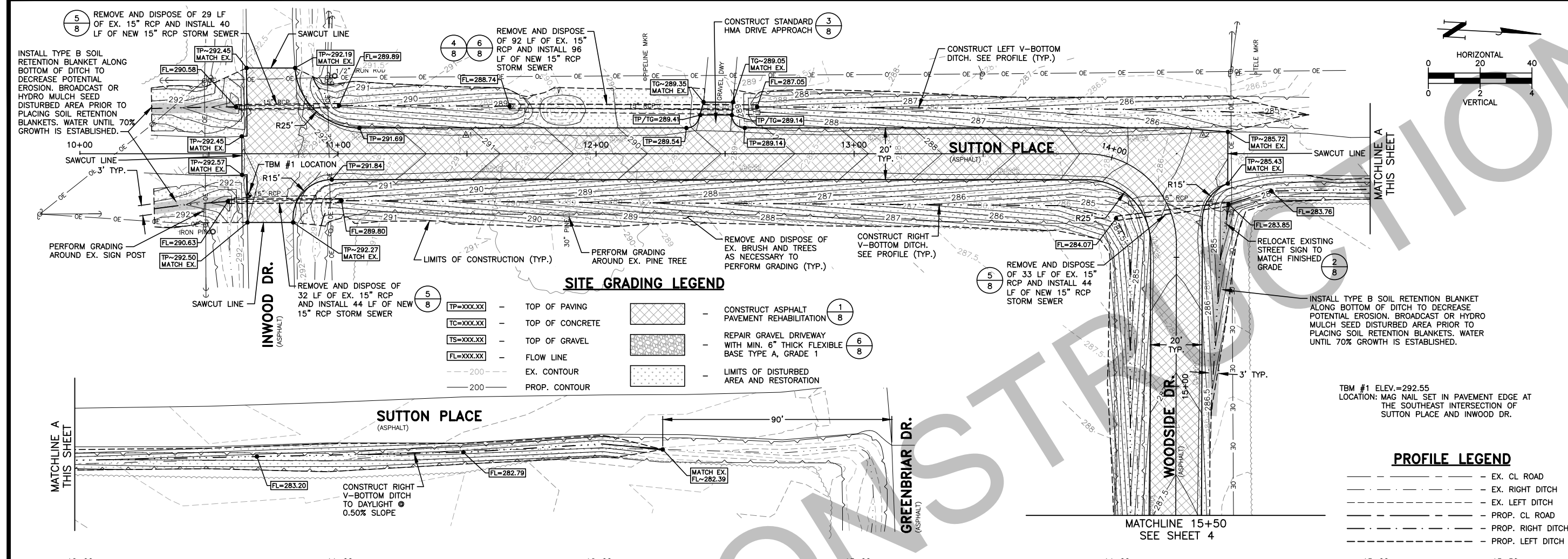

This document is released for the purpose of review under the authority of Jared D. Engelke, P.E., 138204 on November 14, 2022. It is not to be used for construction, bidding, or permit purposes.

NO.	REVISIONS	DATE:

SITE GRADING LEGEND

TP=XXX.XX	- TOP OF PAVING	[Pattern]	- CONSTRUCT ASPHALT PAVEMENT REHABILITATION	1/8
TC=XXX.XX	- TOP OF CONCRETE	[Pattern]	- REPAIR GRAVEL DRIVEWAY WITH MIN. 6" THICK FLEXIBLE BASE TYPE A, GRADE 1	6/8
TS=XXX.XX	- TOP OF GRAVEL	[Pattern]	- LIMITS OF DISTURBED AREA AND RESTORATION	
FL=XXX.XX	- FLOW LINE	[Pattern]		
-200	- EX. CONTOUR			
-200	- PROP. CONTOUR			

PROFILE LEGEND

[Symbol]	- EX. CL ROAD
[Symbol]	- EX. RIGHT DITCH
[Symbol]	- EX. LEFT DITCH
[Symbol]	- PROP. CL ROAD
[Symbol]	- PROP. RIGHT DITCH
[Symbol]	- PROP. LEFT DITCH

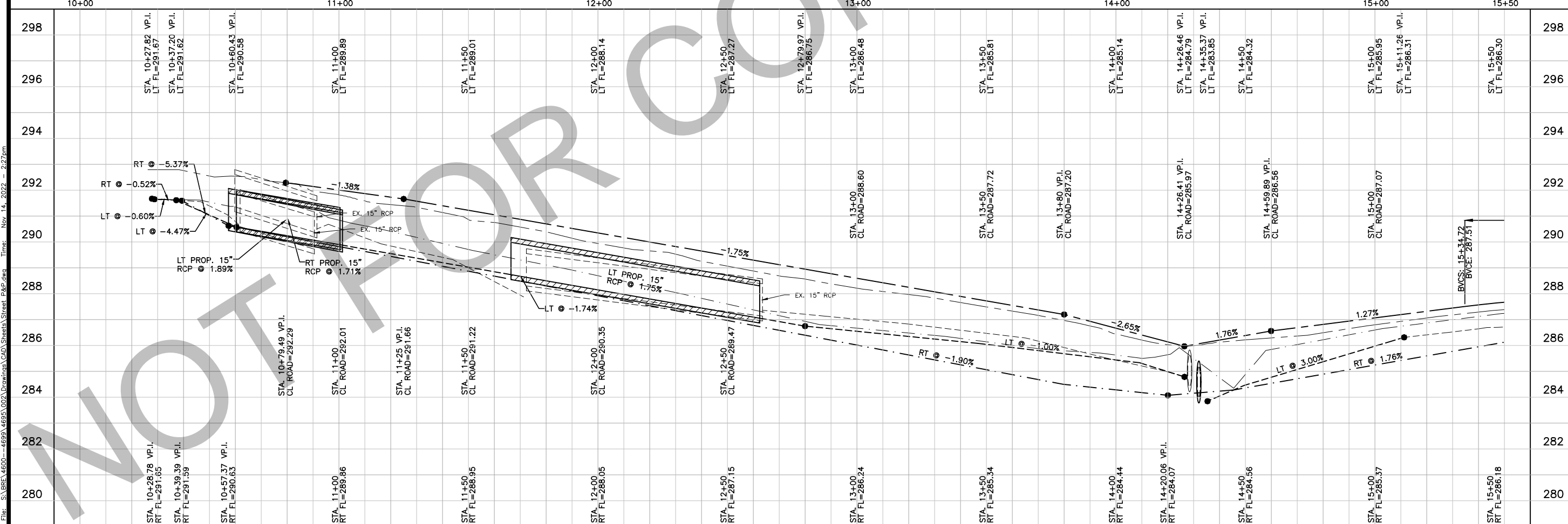

SUTTON PLACE PLAN AND PROFILE
STA. 10+00 - 15+50
CITY OF TODD MISSION
2022 TxCDBG STREET REHABILITATION

JOB NO.
4695.002

PROJECT MGR.
JDE

TBPE No. F-8405

STRAND ASSOCIATES

SHEET
3

This document is released for the purpose of review under the authority of Jared D. Engelke, P.E., 138204 on November 14, 2022. It is not to be used for construction, bidding, or permit purposes.

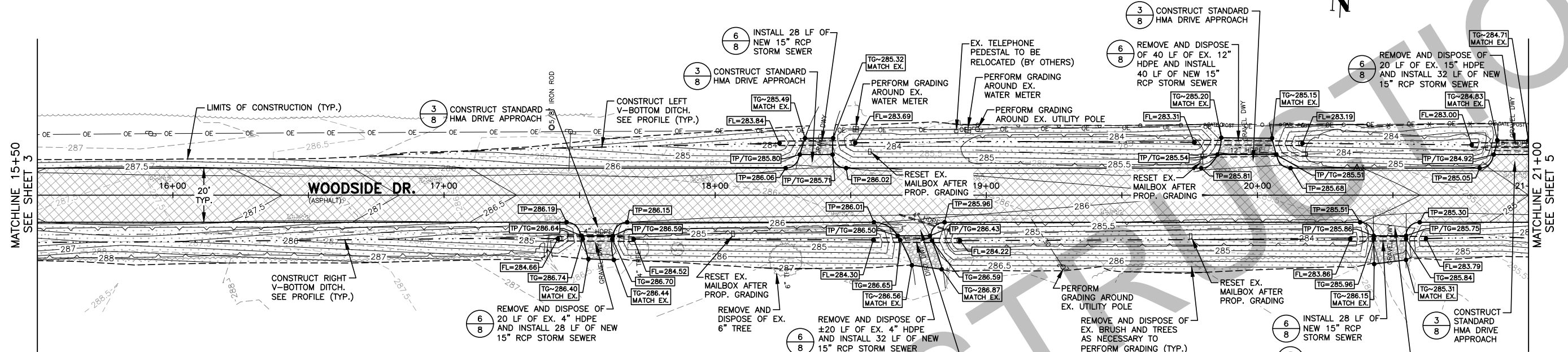
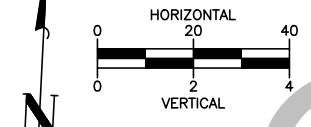

PROFILE LEGEND

- EX. CL ROAD
- EX. RIGHT DITCH
- EX. LEFT DITCH
- PROP. CL ROAD
- PROP. RIGHT DITCH
- PROP. LEFT DITCH

SITE GRADING LEGEND

- TP=XXX.XX - TOP OF PAVING
- TC=XXX.XX - TOP OF CONCRETE
- TS=XXX.XX - TOP OF GRAVEL
- FL=XXX.XX - FLOW LINE
- 200--- EX. CONTOUR
- 200--- PROP. CONTOUR
- [Hatched Box] - CONSTRUCT ASPHALT PAVEMENT REHABILITATION
- [Dotted Box] - REPAIR GRAVEL DRIVEWAY WITH MIN. 6" THICK FLEXIBLE BASE TYPE A, GRADE 1
- [Cross-hatched Box] - LIMITS OF DISTURBED AREA AND RESTORATION

TBM #1 ELEV.=292.55
LOCATION: MAG NAIL SET IN PAVEMENT EDGE AT THE SOUTHEAST INTERSECTION OF SUTTON PLACE AND INWOOD DR.

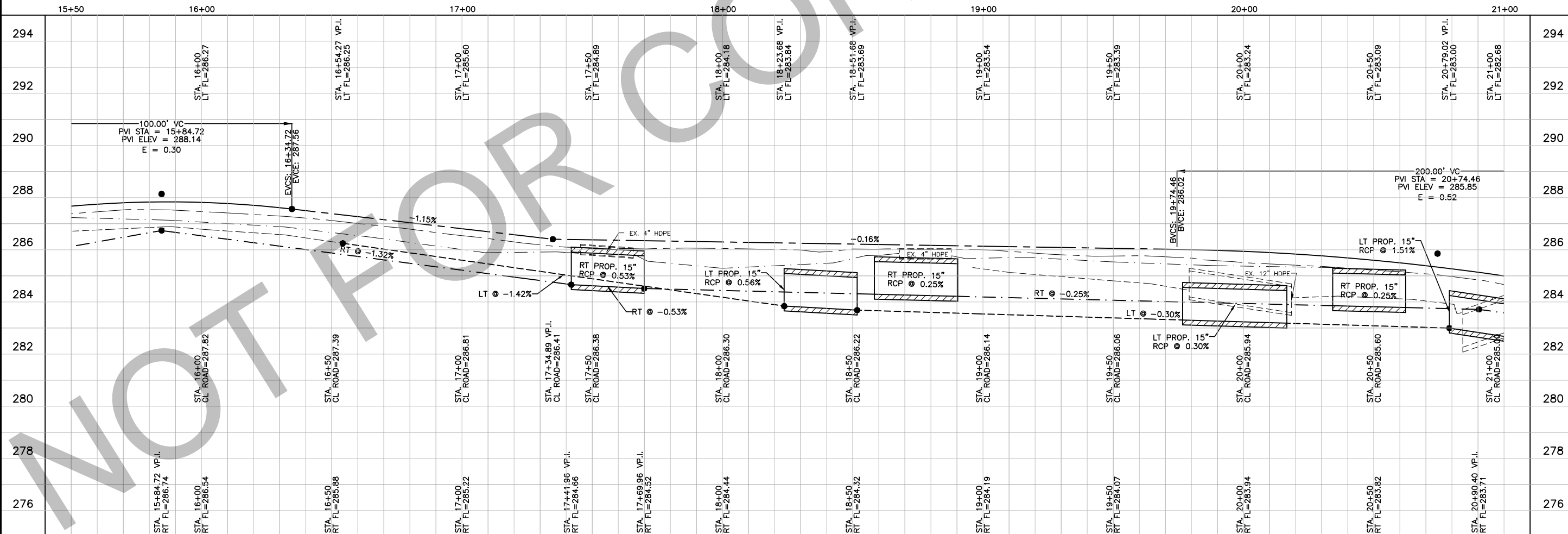

DATE:	REVISIONS:	NO.:

**WOODSIDE DR. PLAN AND PROFILE
STA. 15+50 - 21+00**
**CITY OF TODD MISSION
2022 TxCDBG STREET REHABILITATION**

JOB NO.
4695.002

PROJECT MGR.
JDE

TBPE No. F-8405

STRAND ASSOCIATES

SHEET
4

File: S:\BREC\1600-4695\1605\002\Drawings\Sheet\Street_P&R.dwg Time: Nov 14, 2022 - 2:28pm

This document is released for the purpose of review under the authority of Jared D. Engelke, P.E. 138204 on November 14, 2022. It is not to be used for construction, bidding, or permit purposes.

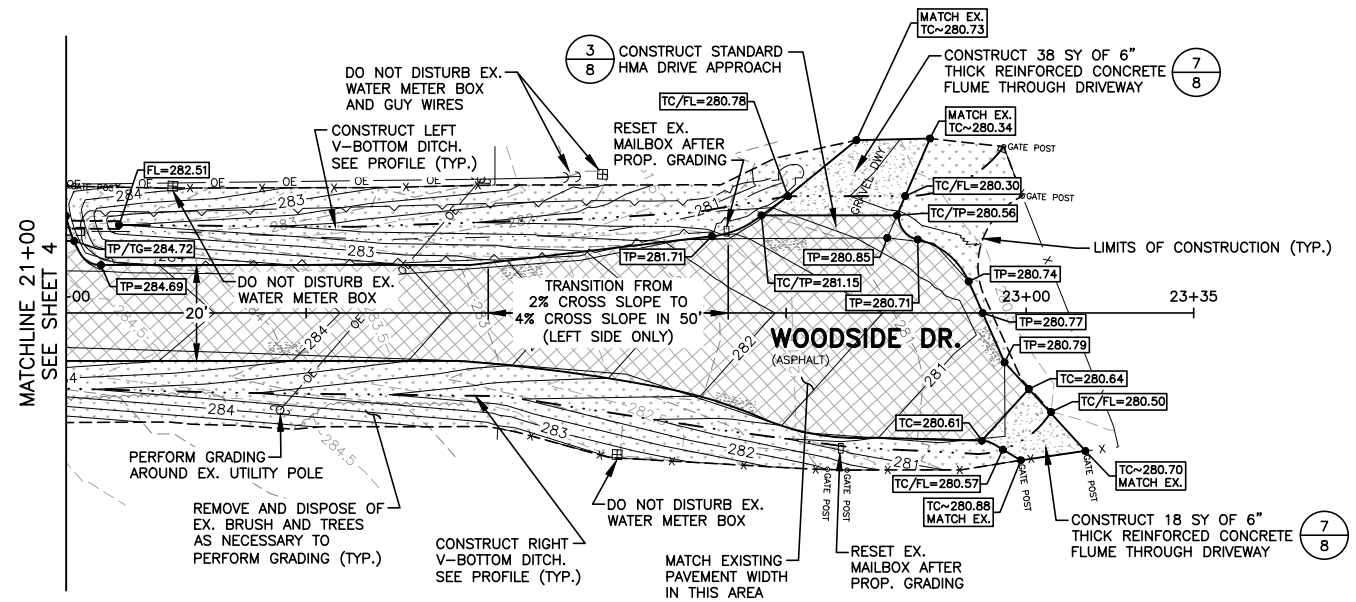

SITE GRADING LEGEND

- TP=XXX.XX - TOP OF PAVING
- TC=XXX.XX - TOP OF CONCRETE
- TS=XXX.XX - TOP OF GRAVEL
- FL=XXX.XX - FLOW LINE
- - - 200 - EX. CONTOUR
- 200 — PROP. CONTOUR
- [Cross-hatch pattern] - CONSTRUCT ASPHALT PAVEMENT REHABILITATION
- [Stippled pattern] - REPAIR GRAVEL DRIVEWAY WITH MIN. 6" THICK FLEXIBLE BASE TYPE A, GRADE 1
- [Dotted pattern] - LIMITS OF DISTURBED AREA AND RESTORATION

PROFILE LEGEND

- — — — — EX. CL ROAD
- - - - - EX. RIGHT DITCH
- - - - - EX. LEFT DITCH
- — — — — PROP. CL ROAD
- - - - - PROP. RIGHT DITCH
- - - - - PROP. LEFT DITCH

TBM #1 ELEV.=292.55
 LOCATION: MAG NAIL SET IN PAVEMENT EDGE AT THE SOUTHEAST INTERSECTION OF SUTTON PLACE AND INWOOD DR.

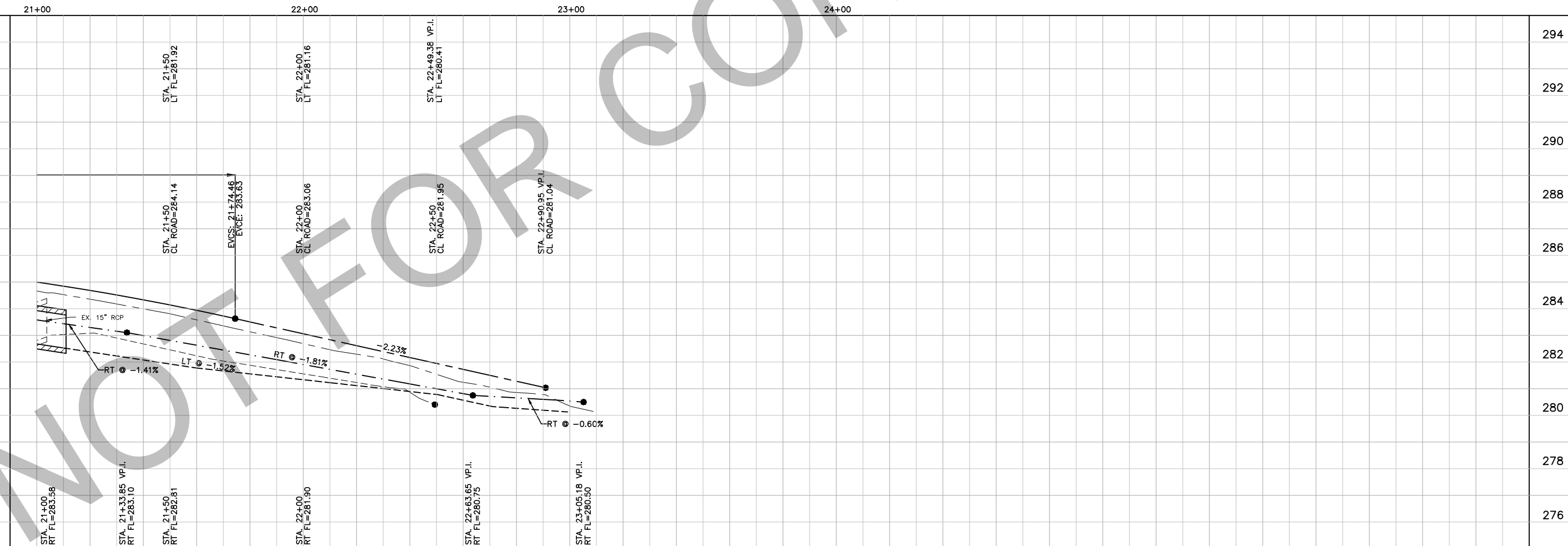
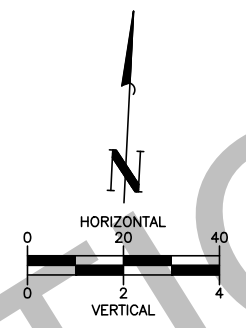

DATE:	REVISIONS	NO.

WOODSIDE DR. PLAN AND PROFILE
STA. 21+00 - 23+35
CITY OF TODD MISSION
2022 TxCDBG STREET REHABILITATION

JOB NO.
4695.002

PROJECT MGR.
JDE

TBPE No. F-8405

STRAND ASSOCIATES

SHEET
5

File: S:\BREC\4695\002\Drawings\002\Drawings\002\Drawings\Street_P&P.dwg Time: Nov 14, 2022 2:28pm

This document is released for the purpose of review under the authority of Jared D. Engelke, P.E. 138204 on November 14, 2022. It is not to be used for construction, bidding, or permit purposes.

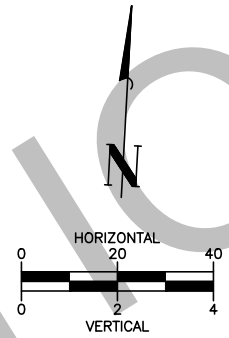
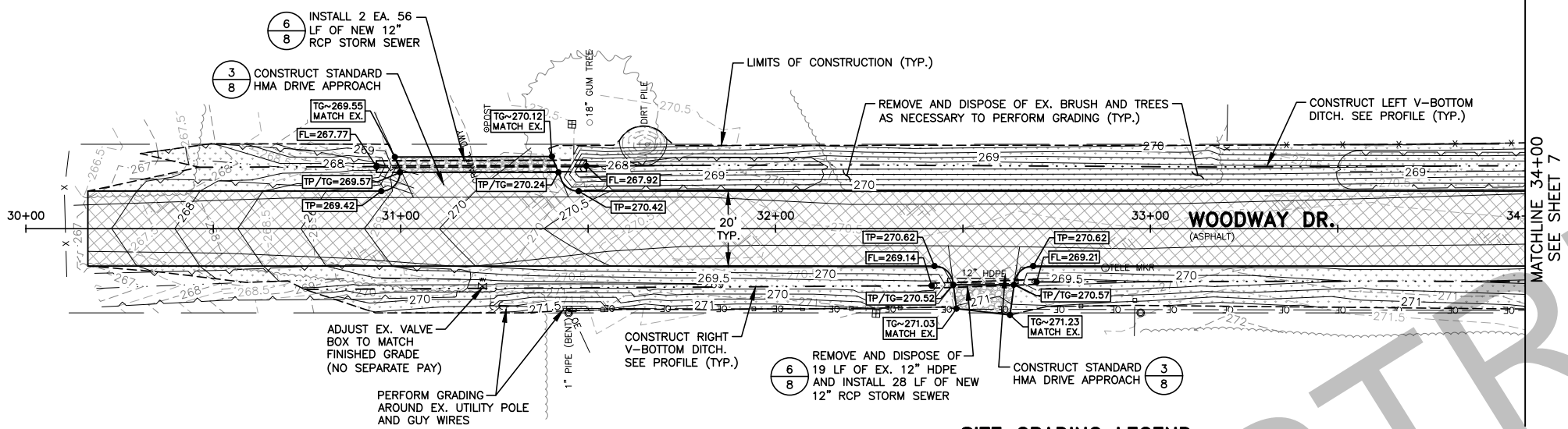

PROFILE LEGEND

- EX. CL ROAD
- EX. RIGHT DITCH
- EX. LEFT DITCH
- PROP. CL ROAD
- PROP. RIGHT DITCH
- PROP. LEFT DITCH

SITE GRADING LEGEND

- TP=XXX.XX - TOP OF PAVING
- TC=XXX.XX - TOP OF CONCRETE
- TS=XXX.XX - TOP OF GRAVEL
- FL=XXX.XX - FLOW LINE
- 200 - EX. CONTOUR
- 200 - PROP. CONTOUR
- [Hatched Box] - CONSTRUCT ASPHALT PAVEMENT REHABILITATION (1/8)
- [Dotted Box] - REPAIR GRAVEL DRIVEWAY WITH MIN. 6\"/>
- [Stippled Box] - LIMITS OF DISTURBED AREA AND RESTORATION

TBM #2 ELEV.=270.76
 LOCATION: MAG NAIL SET IN PAVEMENT EDGE ON THE EAST SIDE OF THE INTERSECTION OF WOODWAY DR. AND MILL CREEK DR.

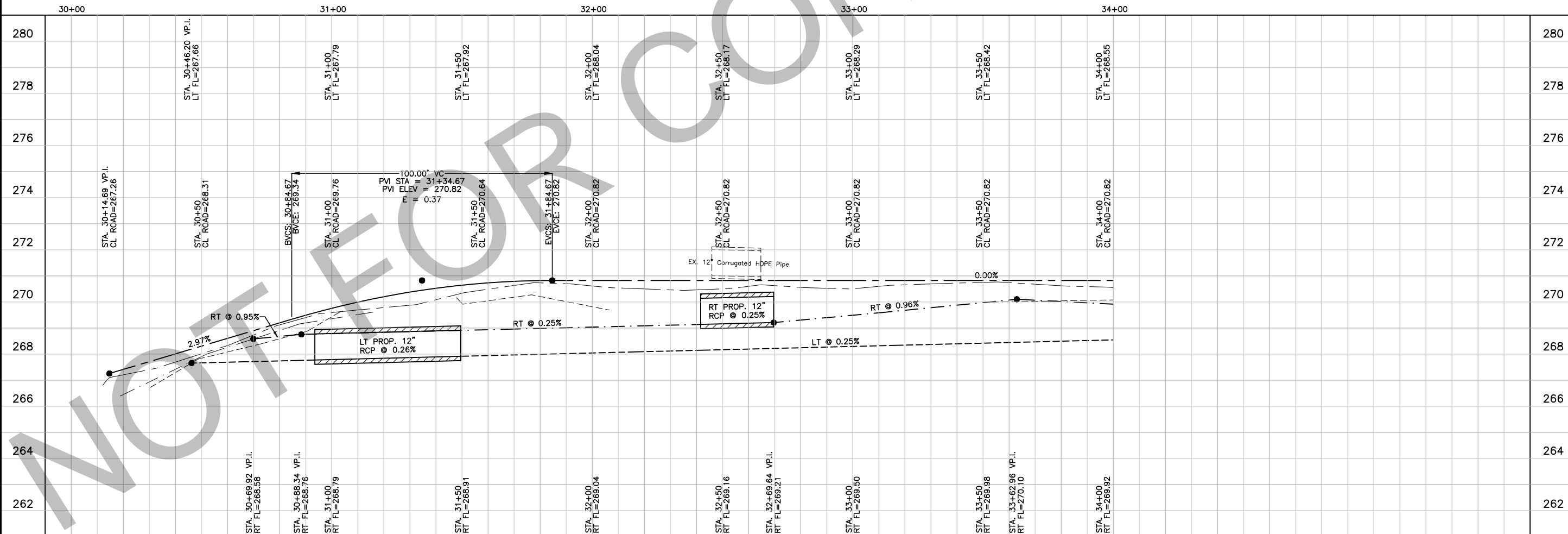

DATE:	REVISIONS	NO.

WOODWAY DR. PLAN AND PROFILE
STA. 30+00 - 34+00
CITY OF TODD MISSION
2022 TxCDBG STREET REHABILITATION

JOB NO.
4695.002

PROJECT MGR.
JDE

TBPE No. F-8405

STRAND ASSOCIATES

SHEET
6

File: S:\BREC\4695\4695\002\Drawings\GAD\Sheets\Street_P&P.dwg Time: Nov 14, 2022 - 2:28pm

This document is released for the purpose of review under the authority of Jared D. Engelke, P.E. 138204 on November 14, 2022. It is not to be used for construction, bidding, or permit purposes.

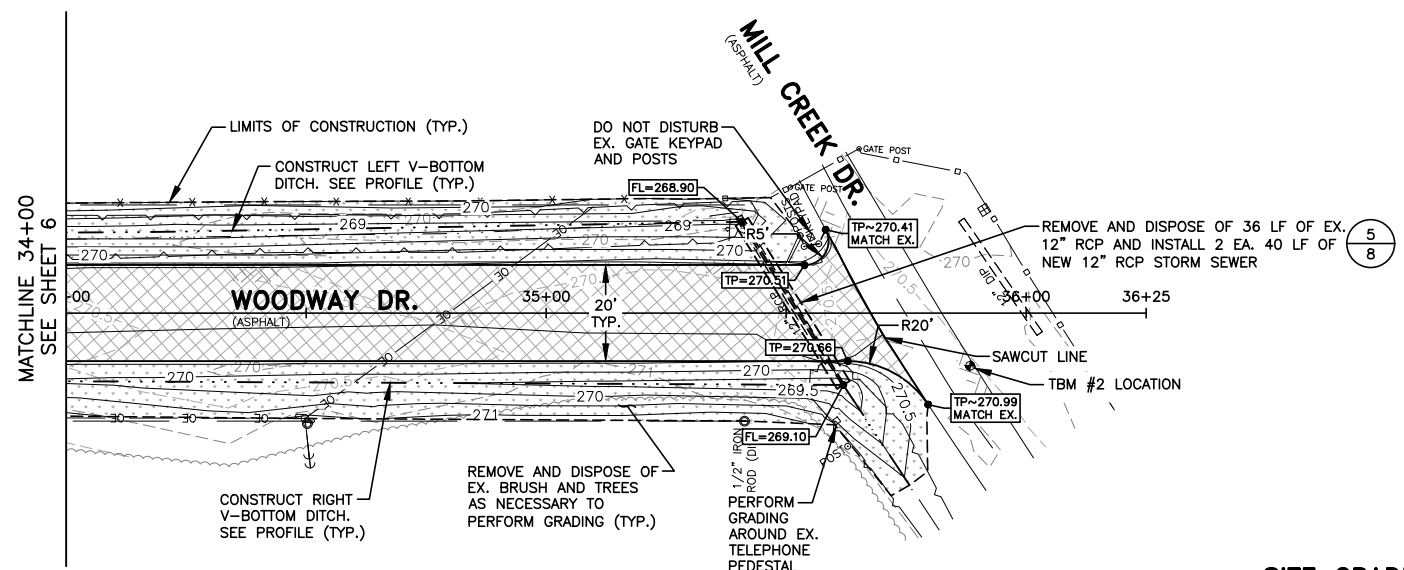
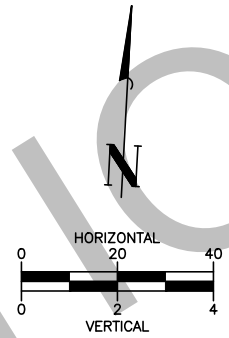

PROFILE LEGEND

- EX. CL ROAD
- EX. RIGHT DITCH
- EX. LEFT DITCH
- PROP. CL ROAD
- PROP. RIGHT DITCH
- PROP. LEFT DITCH

SITE GRADING LEGEND

- TP=XXX.XX - TOP OF PAVING
- TC=XXX.XX - TOP OF CONCRETE
- TS=XXX.XX - TOP OF GRAVEL
- FL=XXX.XX - FLOW LINE
- - - 200 - EX. CONTOUR
- 200 - PROP. CONTOUR
- [Cross-hatch pattern] - CONSTRUCT ASPHALT PAVEMENT REHABILITATION
- [Stippled pattern] - REPAIR GRAVEL DRIVEWAY WITH MIN. 6" THICK FLEXIBLE BASE TYPE A, GRADE 1
- [Dotted pattern] - LIMITS OF DISTURBED AREA AND RESTORATION

1/8
6/8

TBM #2 ELEV.=270.76
LOCATION: MAG NAIL SET IN PAVEMENT EDGE ON THE EAST SIDE OF THE INTERSECTION OF WOODWAY DR. AND MILL CREEK DR.

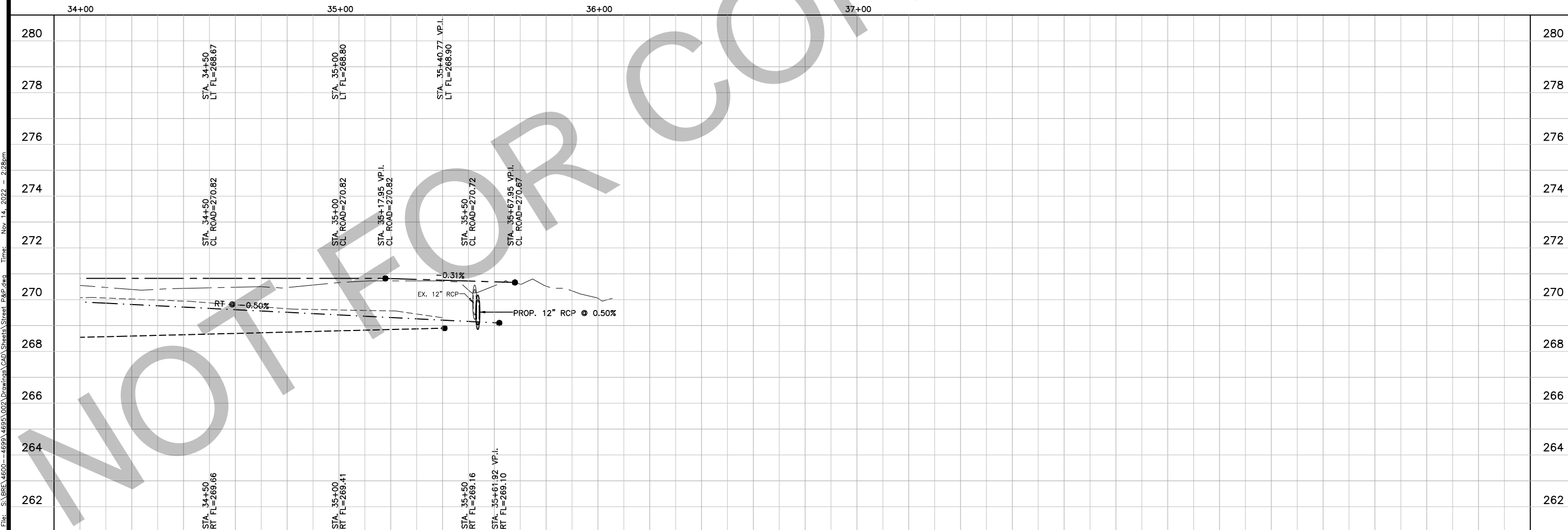

DATE:	REVISIONS	NO.

WOODWAY DR. PLAN AND PROFILE
STA. 34+00 - 36+25
CITY OF TODD MISSION
2022 TxCDBG STREET REHABILITATION

JOB NO.
4695.002

PROJECT MGR.
JDE

TBPE No. F-8405

STRAND ASSOCIATES

SHEET
7

File: S:\BREC\4695\4695\002\Drawings\GAU\Sheets\Street_P&P.dwg Time: Nov 14, 2022 - 2:28pm

This document is released for the purpose of review under the authority of Jared D. Engleke, P.E. 138204 on November 14, 2022. It is not to be used for construction, bidding, or permit purposes.

NO.	REVISIONS	DATE

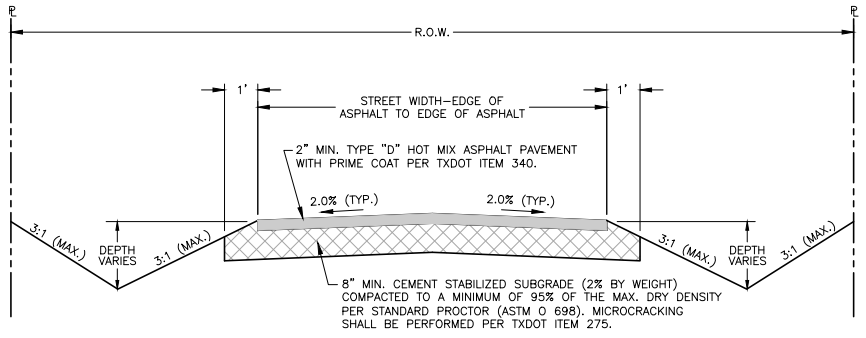

1 TYPICAL ASPHALT PAVEMENT REHABILITATION SECTION
NTS

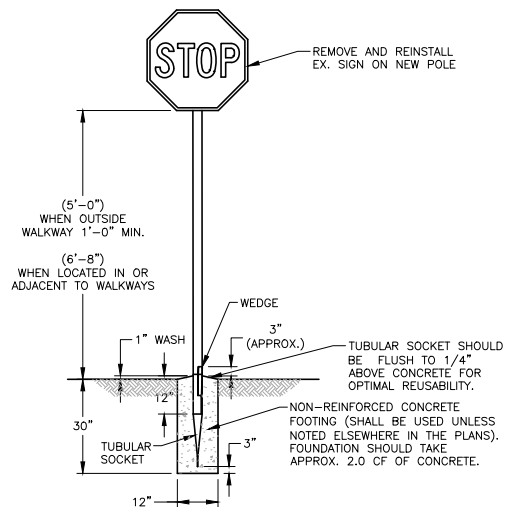

2 STREET & TRAFFIC CONTROL SIGN
NTS

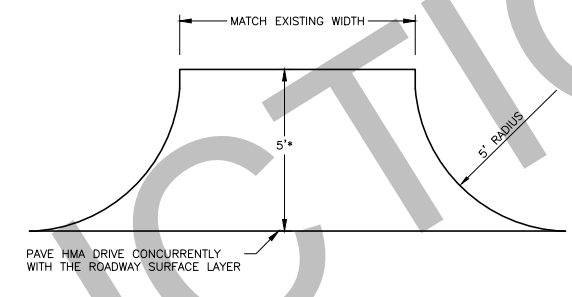

3 STANDARD HMA DRIVE APPROACH
NTS
*UNLESS OTHERWISE SHOWN ON DRAWINGS

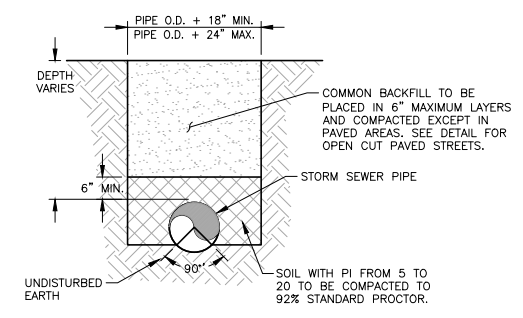

4 TYPICAL SECTION OPEN CUT
NTS

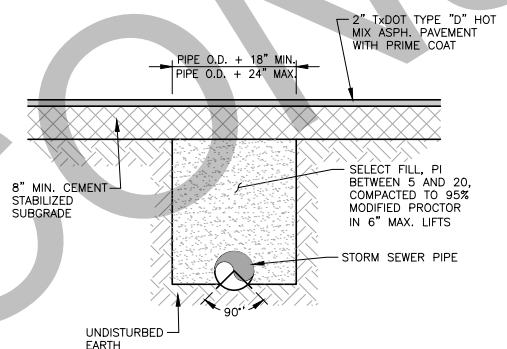

5 TYPICAL SECTION OPEN CUT PAVED STREET
NTS

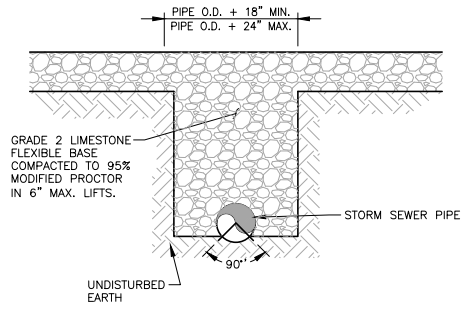

6 TYPICAL SECTION OPEN CUT GRAVEL DRIVEWAY
NTS

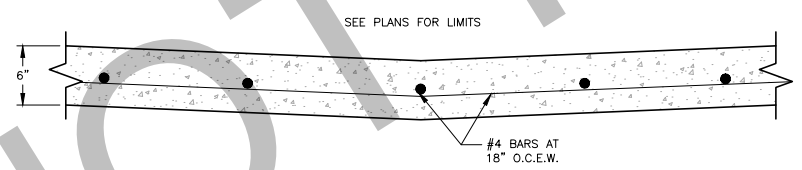

7 REINFORCED CONCRETE FLUME
NTS

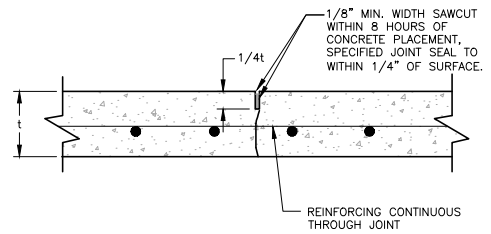

8 SAW CUT CONTRACTION JOINT
NTS

(15' MAXIMUM PANEL WIDTH AND LENGTH)

PAVING DETAILS

CITY OF TODD MISSION
2022 TXCDBG STREET REHABILITATION

JOB NO.
4695.002
PROJECT MGR.
JDE
TBPE No. F-8405



SHEET
8

File: S:\BRE\4695\002\Drawings\CAU\Sheets\PS\F.dwg Time: Nov 14, 2022 2:28pm